

00000000

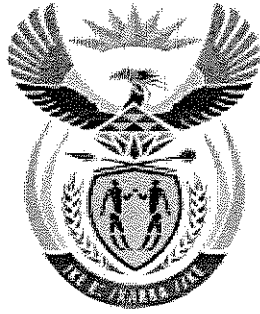

# higher education & training

Department:  
Higher Education and Training  
REPUBLIC OF SOUTH AFRICA

## MARKING GUIDELINE

NATIONAL CERTIFICATE

AUGUST EXAMINATION

QUANTITY SURVEYING N4

29 JULY 2014

*[Signature]*  
07/08/2014

*[Signature]*  
07/08/2014

This marking guideline consists of 7 pages.

*[Signature]*  
DHET

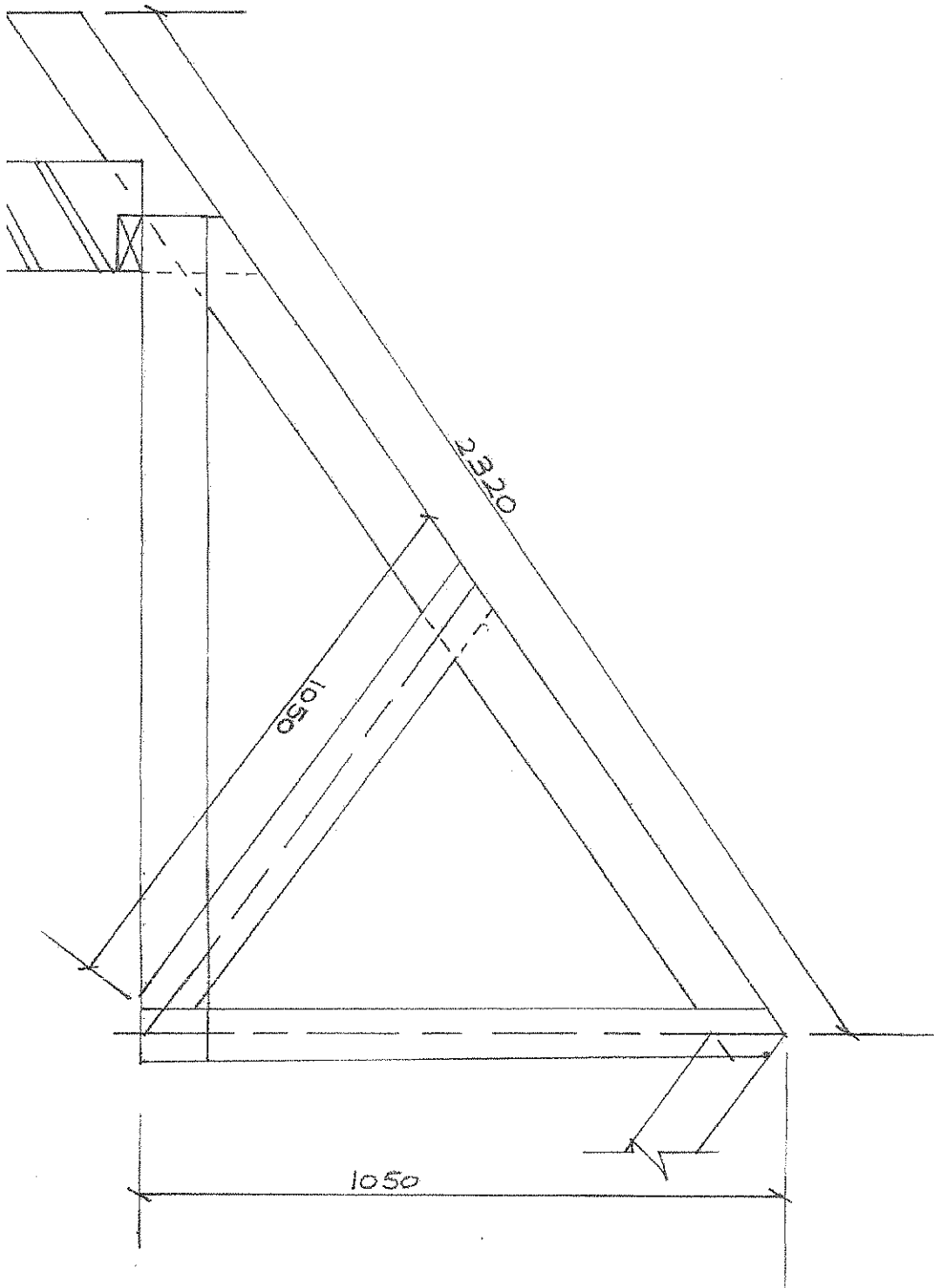

Accuracy  
Dimensions

(2)  
(1)

NB QUESTION 1.2 and 1.4 are ambiguous and they do not correlate!!!

1.2 ~~Roof covering~~  
TRUSSES

Checklist

- Trusses in Wall 10
- King post
- Rafter
- tie beam
- Wall plate
- Roof tie
- Splay cut

Number of trusses  
6000  
- 2/20 440  
5560 ÷ 700  
= 7,94 ~~spaces~~  
Say 8+1 = 9 trusses

The following 38x114mm  
Pretreated South African  
Pine timber members  
not exceeding 2.4m

9	1.05	9.45	King post ✓
2	2.32	41.36	Rafter ✓
9	3.18	28.62	Tie beam ✓
2	5.56	11.12	Ditto Wall plate 38x114mm ✓
2	9.1	18.2	Ditto 38x114mm S.A.P Pine timber member not exceeding 2.4m ✓
2	9.45	18.90	Strut ✓

9	2	18	Splay cut to end of rafters ✓ (and) roof ties ✓
END OF TRUSSES			

1.2 Roof covering  
Checklist

- Purlins
- Covering ✓
- Ridge piece
- Fascia board
- Barge board

2	3	6.20	37.20	56x76mm S.A.P Purlins ✓ or Purlins ✓
6000 + 2/100 200 <u>6200</u>				
2	6.20	12.40	76x76mm Wrot eaves Purlins ✓	
2	6.20	26.32	Galvanised steel iron sheet roof covering ✓	
2	6.20	12.40	Ditto ridge piece ✓	
2	2	2.32	38x220 barge board ✓	
2	6.20	12.40	Ditto fascia board ✓	
END OF MEASURE!!				
END OF MEASURE				

Rain Water goods

checklist

- Gutters
- Down pipe
- Outlet
- Stopped end ✓
- Offset ✓
- Shoe
- Channel

2/6.20 ✓

100x75mm galvanised  
Sheet iron eaves gutter  
incl brackets

2/2 ✓

100x75mm g.s.i  
down pipe incl brackets

2/2 ✓

Extra on g.s.i  
down pipe for offset

and

D.o for outlet

and

D.o for shoe

and ✓

D.o for rain water  
channel ✓

2/2 ✓

bitto for extra on  
g.s.i gutter for  
stopped ends

NB Question 1.3  
any 11 (eleven)

Question 1.4

NB

- (1) Squaring any FOUR
- (4) 12 mark including abstracting and billing
- (11) Squaring 1/2 mark Per item.

Question 1.2

Carpentry and Joinery

M

The following 38mm x 114mm pre-treated South African pine timber members not exceeding 2.4m.

52.76

53

M

Ditto exceeding 2.4m not exceeding 3.9m (tie beam)

28.62

29

M

38 x 114mm Wall plate

11.12

11

M

38mm x 114mm Strut

18.90

19

N

Splay cut to end of rafters

18

M

50 x 76mm S.S.A Pine

37.20

37

M

76mm x 76mm Wood eave Purline

12.40

12

NB ANY5

Carpentry and Joinery

Bill no.-----

1	The following 38mm x 114mm pre-treated South African pine timbers members not exceeding 2,4m	m	53
2	Exceeding 2.4m not exceeding 3.9mm	m	29
3	38mm x 114mm Wall plate	m	11
4	38mm x 114mm Strut	m	19
5	Splay cuts to end of rafters	no	18
6	50mm x 76mm Sawn South African Pine Purlins	m	37
7	76mm x 76mm Sawn South African Pine Purlins	m	12

Carried forward to summary

AND 5 x 1 (5)

**SECTION B****QUESTION 2**

- |     |                                                                                                                                                                                                                                                                                                                                                                                                                                                                                                                                                                                  |                                                      |          |             |
|-----|----------------------------------------------------------------------------------------------------------------------------------------------------------------------------------------------------------------------------------------------------------------------------------------------------------------------------------------------------------------------------------------------------------------------------------------------------------------------------------------------------------------------------------------------------------------------------------|------------------------------------------------------|----------|-------------|
| 2.1 | 2.1.1                                                                                                                                                                                                                                                                                                                                                                                                                                                                                                                                                                            | External cement plaster on brick horizontal surfaces |          |             |
|     | 2.1.2                                                                                                                                                                                                                                                                                                                                                                                                                                                                                                                                                                            | Knot prime and stop 2 coats enamel on timber doors   |          |             |
|     | 2.1.3                                                                                                                                                                                                                                                                                                                                                                                                                                                                                                                                                                            | Extra for fair face                                  |          |             |
|     | 2.1.4                                                                                                                                                                                                                                                                                                                                                                                                                                                                                                                                                                            | Formwork to edge of slab not exceeding 150 mm high   |          |             |
|     | 2.1.5                                                                                                                                                                                                                                                                                                                                                                                                                                                                                                                                                                            | Risk of collapse to sides of trenches.               | (5 × 2)  | (10)        |
| 2.2 | 2.2.1                                                                                                                                                                                                                                                                                                                                                                                                                                                                                                                                                                            | Number                                               |          |             |
|     | 2.2.2                                                                                                                                                                                                                                                                                                                                                                                                                                                                                                                                                                            | Square meters                                        |          |             |
|     | 2.2.3                                                                                                                                                                                                                                                                                                                                                                                                                                                                                                                                                                            | Square meters                                        |          |             |
|     | 2.2.4                                                                                                                                                                                                                                                                                                                                                                                                                                                                                                                                                                            | Meter                                                |          |             |
|     | 2.2.5                                                                                                                                                                                                                                                                                                                                                                                                                                                                                                                                                                            | Number                                               | (5 × 1)  | (5)         |
| 2.3 | <p>Finishes shall be given in square meters and shall be measured over the net area to be covered. Finishes not exceeding 300 mm wide except to treads and risers and stairs, columns, beams, troughed, ribbed and coffered work and that in flush face caused by projections and openings shall be described as narrow widths and shall be given separately in square metre, no distinction being made for different elements.</p> <p>No deductions shall be made for openings, wants, etc. not exceeding 0,5 m<sup>2</sup>. Description shall be deemed to include curing.</p> |                                                      |          |             |
|     |                                                                                                                                                                                                                                                                                                                                                                                                                                                                                                                                                                                  |                                                      | any Five | (5)         |
|     |                                                                                                                                                                                                                                                                                                                                                                                                                                                                                                                                                                                  |                                                      |          | <b>[20]</b> |

**QUESTION 3**

- |     |       |      |          |      |
|-----|-------|------|----------|------|
| 3.1 | 3.1.1 | True |          |      |
|     | 3.1.2 | True |          |      |
|     | 3.1.3 | True |          |      |
|     | 3.1.4 | True |          |      |
|     | 3.1.5 | True |          |      |
|     | 3.1.6 | True |          |      |
|     | 3.1.7 | True |          |      |
|     | 3.1.8 | True |          |      |
|     | 3.1.9 | True |          |      |
|     | 3.1.0 | True | (10 × 1) | (10) |

3.2	3.2.1	Owner / CLIENT		
	3.2.2	Architect		
	3.2.3	Owner / CLIENT		
	3.2.4	Quantity surveyor		
	3.2.5	Owner / CLIENT		
	3.2.6	Engineer		
	3.2.7	Civil engineer		
	3.2.8	Structural engineer		
	3.2.9	Mechanical engineer		
	3.2.10	Electrical engineer		
			(10 × 1)	(10)
				<b>[20]</b>

**QUESTION 4**

- 4.1
- Check the sizes of the room and compare with the overall sizes.
  - Reference all dimensions as clearly as possible.
  - Colour the plans with coloured pencils to make them stand out clearly, but only section by section as they are measured.
  - Write the dimensions clearly and do not crowd them.
  - Always use the figured dimensions from plans.
  - Do not scale unless absolutely sure.
  - Use plenty of headings and sub-headings to indicate sections.
  - Make a practice of being systematic and methodical in order of taking off.
- (Any 5 × 1) (5)
- 4.2 The work shall be divided into trades or sections are divided into subsections.
- Within all sub-sections the order followed shall be mass, volume, area, length and number.
- Subject to 1 and 2, the items shall be placed in their approximate value, the cheapest first.
- 4.3 Pre contract work comprises of all the work done from the time the quantity surveyor is appointed up to the signing of the contract before commencement of the actual work.
- The work includes the following:
- Estimating, cost planning and control
  - Preparation of the bills of quantities
  - Obtaining tenders
  - Writing specifications
  - Preparation of schedules of rates
- (5)
- [20]**

**TOTAL SECTION B: 60**  
**GRAND TOTAL: 100**