



**higher education
& training**

Department:
Higher Education and Training
REPUBLIC OF SOUTH AFRICA

MARKING GUIDELINE

NATIONAL CERTIFICATE

NOVEMBER EXAMINATION

BUILDING AND STRUCTURAL CONSTRUCTION N4

28 NOVEMBER 2016

This marking guideline consists of 9 pages.

QUESTION 1

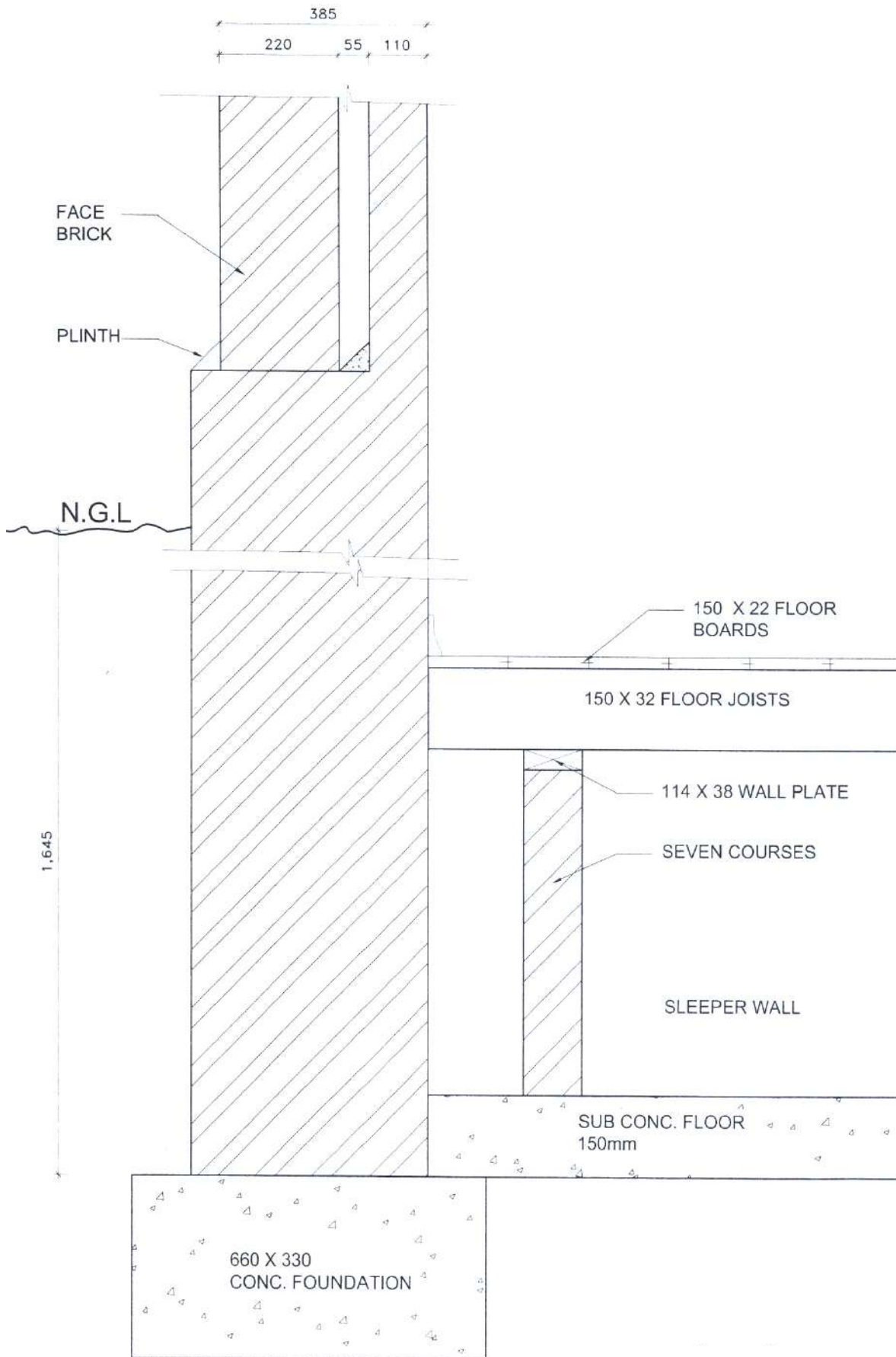

[20]

QUESTION 2

- 2.1 Racking back is done when a straight piece of wall is built halfway from its end, so that the remaining piece can join into the existing wall and the bond maintained.

OR

**RACKING BACK**

(4)

- 2.2
- It serves as a level base for walling.
 - It provides a wider area over which the weight of the wall and its supporting parts can be spread.
 - Overturning in soft soil is prevented.
 - A linked frame is provided for the building to rest upon.
 - An indirect support for the floors is provided.

(5 × 1)

(5)

2.3

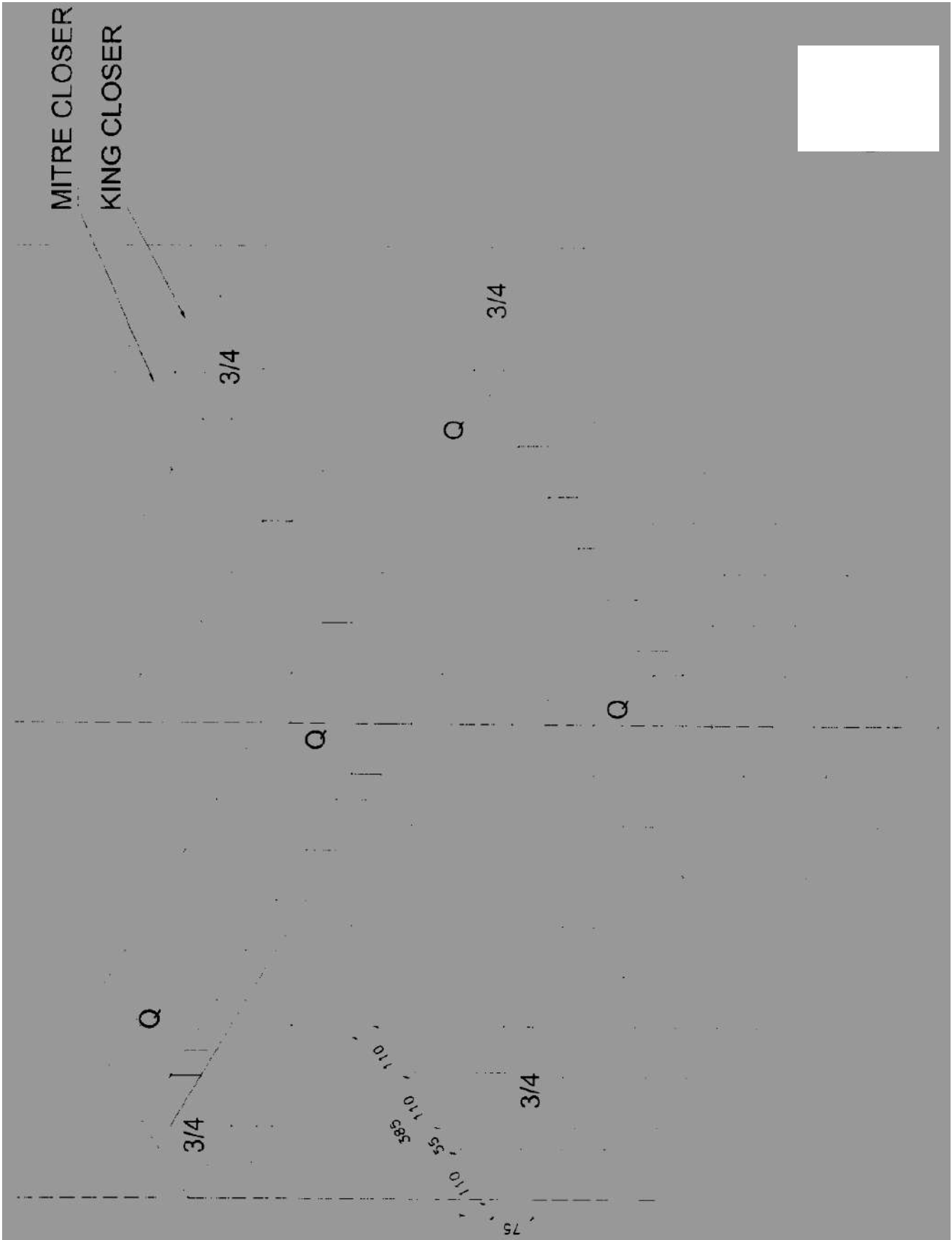

(7)
[16]

QUESTION 3

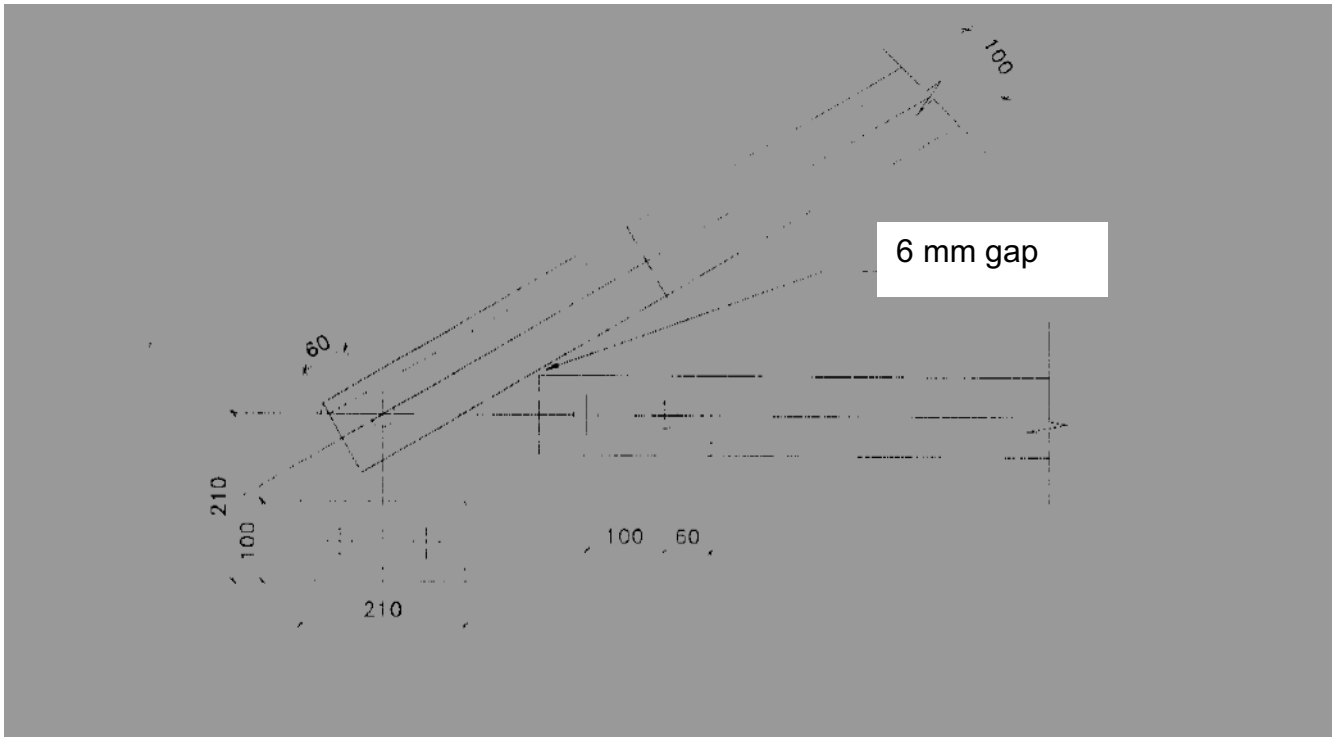

FOOT STEEL ROOF TRUSS

SCALE 1 : 5

[20]

QUESTION 4

1. Depth
2. Key brick
3. Voussoir
4. Extrados
5. Screw back
6. Rise
7. Springing line
8. Intrados
9. Span

[9]

QUESTION 5

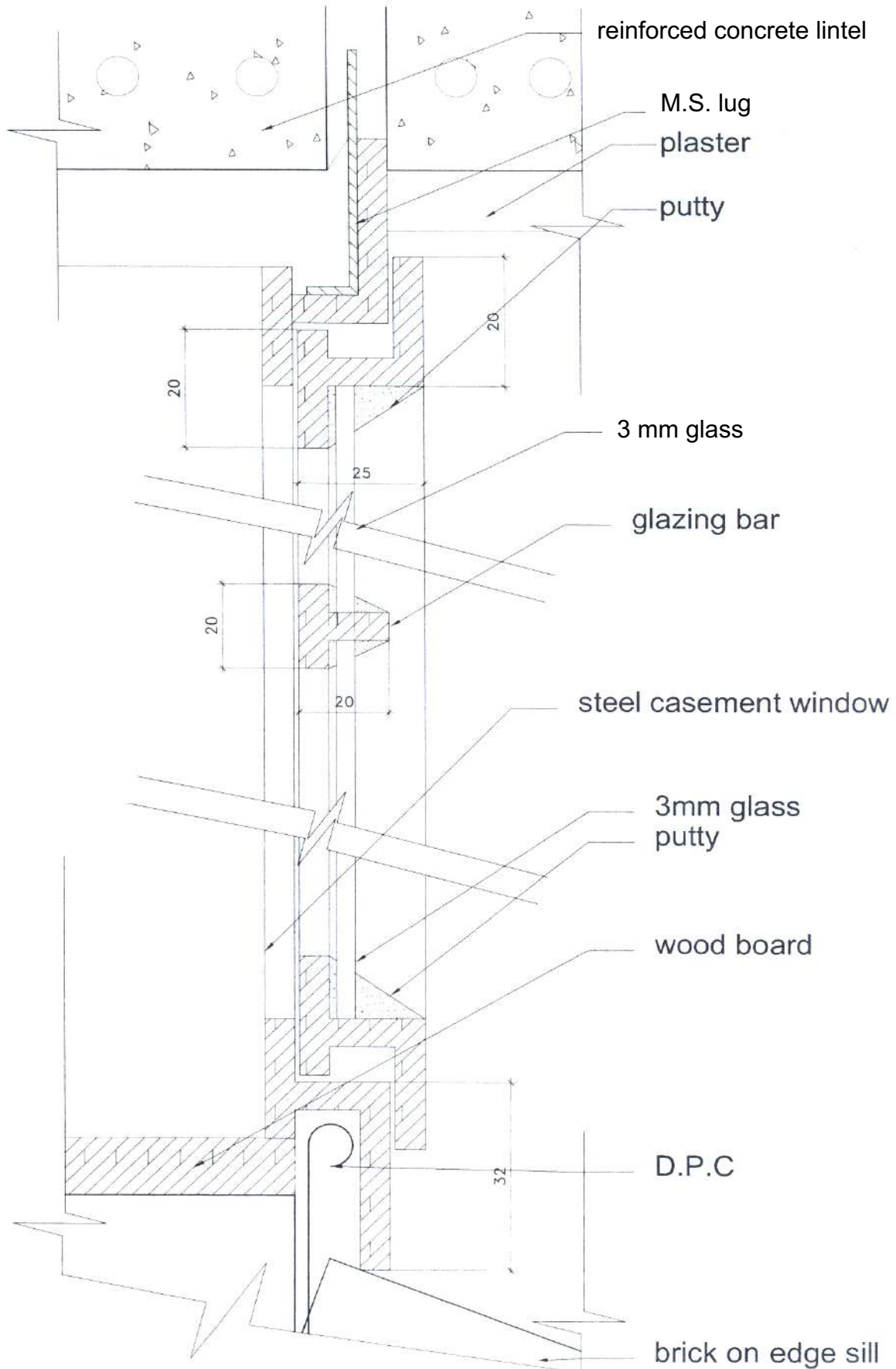

**SECTION THROUGH STEEL WINDOW
SCALE 1 : 2**

[15]

QUESTION 6

6.1

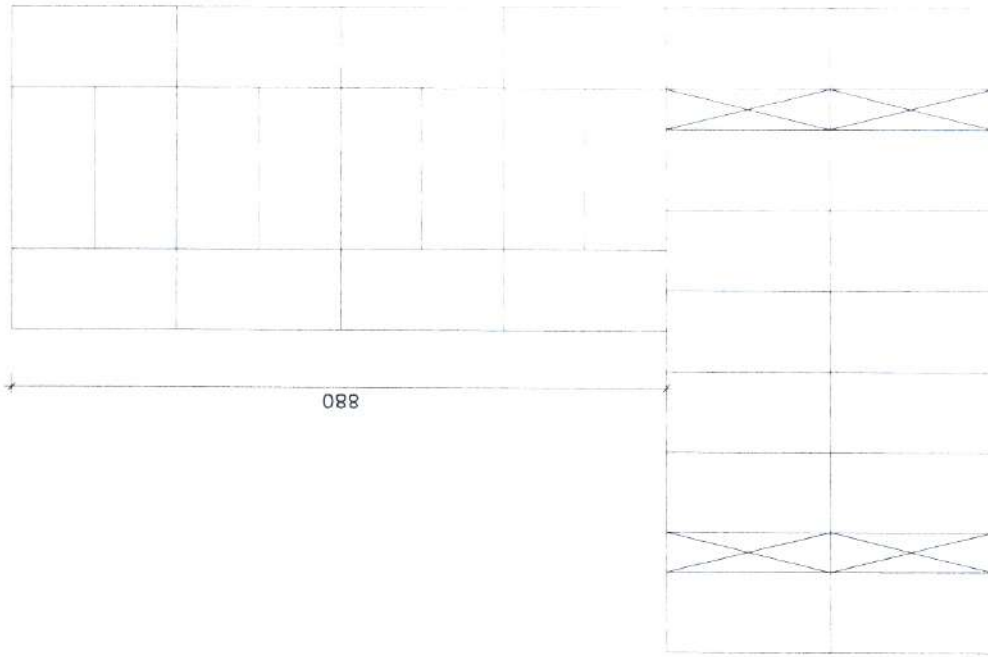

TWO-BRICK CORNER

SCALE 1 : 10

(10)

6.2

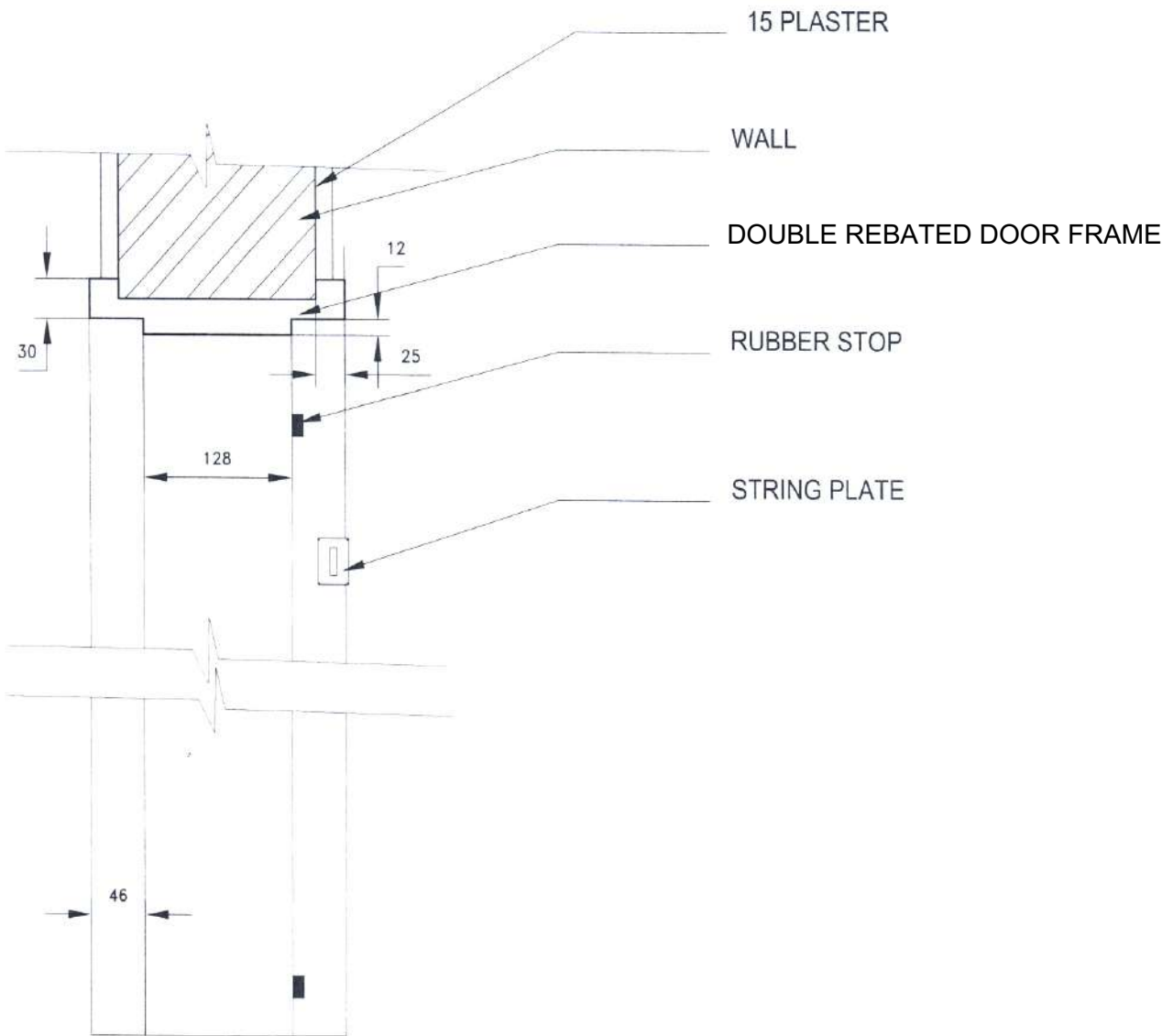

SACLE 1 : 5

(10)

[20]

TOTAL: 100