

# higher education & training

Department:  
Higher Education and Training  
REPUBLIC OF SOUTH AFRICA

## MARKING GUIDELINE

NATIONAL CERTIFICATE

AUGUST EXAMINATION

BRICKLAYING AND PLASTERING THEORY N2

22 JULY 2014

This marking guideline consists of 6 pages.

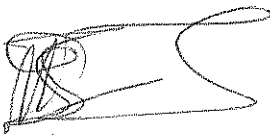
(BRITS) CM  JACOBS 7/08/2014

(CENTURION) CM  SEPHEREPHE W.B 7/08/2014

(CENTURION) IM  SIGWILI 7/08/2014

(MPONDOZANIKONDO) CM  MTOGOALE 07/08/2014

 DHET

## QUESTION 1

- 1.1
- Base screeds ✓
  - Corner beads ✓
  - Metal casings ✓
- (3)
- 1.2 The wire for exterior use must be of a thicker gauge✓ or bigger gauge✓ or larger gauge✓ than laths for interior use. (1)
- OR
- The wire for interior use must be of a smaller gauge✓ than that of exterior use. (1)
- 1.3
- 1.3.1 Breeze blocks – Furnace klinker, Portland cement ✓
- 1.3.2 Pumice blocks – Broken bricks, Portland cement ✓
- 1.3.3 Wood-wool slabs – Wood shavings bonded✓ with magnesite fibres or cement
- 1.3.4 Cork slabs – Bark of trees✓, natural resin acts as bonding agent  
(4 × 1) (4)
- 1.4
- Plate✓
  - Stock✓
  - Shoes✓
  - Muffle plate✓
  - Stays✓
  - Cleats ✓
  - slipper ✓
- (6)  
( Any 6 × 1) [14]

QUESTION 2

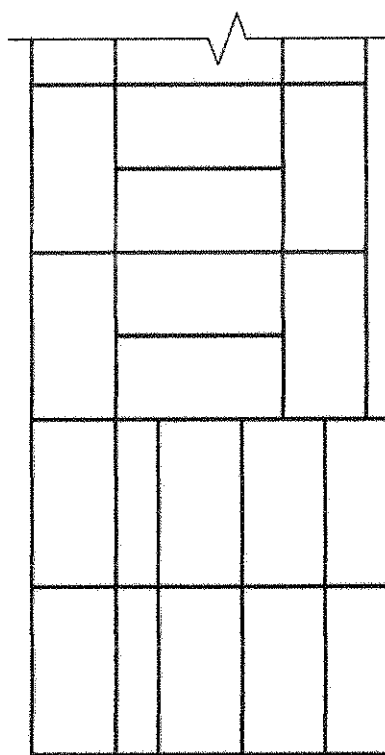

- Approximate scale =2
- Correct bond to 2 brick main wall =2
- Correct bond to 2 brick adjoining wall =2
- Correct bonding at corner =2
- Correct stopped end =2
- 10

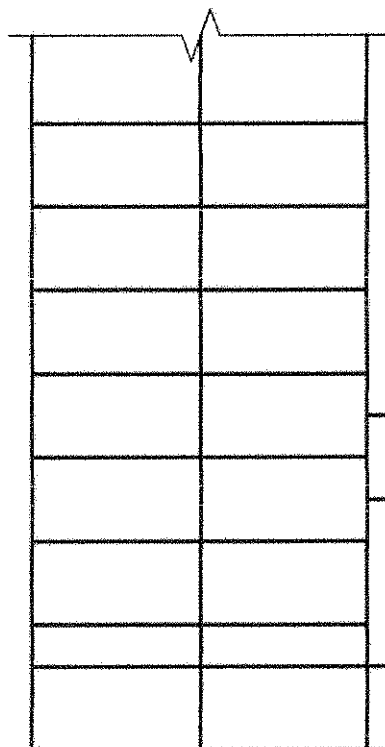

- Approximate scale =2
- Correct bond to 2 brick main wall =2
- Correct bond to 2 brick adjoining wall =2
- Correct bonding at corner =2
- Correct stopped end =2
- 10

ALTERNATE PLAN COURSES OF A TWO BRICK CORNER IN ENGLISH BOND WITH STOPPED END AT ONE WALL END.

[20]

**QUESTION 3**

- 3.1 Fix a batten with the top edge the height of one tile from the floor✓  
Determine the centre line of the wall and draw a plumb line✓  
Nail a batten to one side of the centre line✓  
Use a notched trowel and apply adhesive to the wall✓  
Start laying the tiles by positioning the first tile on the horizontal batten against the vertical batten✓  
Fill the one half with tile using spacers✓, maintaining plumb vertical and horizontal joints✓  
Remove the vertical batten and lay the remaining half using spacers✓  
Measure, cut and lay the cut tiles around the edge ✓  
Remove the horizontal batten✓ and lay the bottom row✓  
Remove the spacers✓  
Fill all the joints with grout ✓  
Remove the excess and clean the tile with a dry cloth ✓ (Any 12 × 1) (12)
- 3.2
- Basket weave✓
  - Herringbone✓
  - Basket weave variation✓
  - Stretcher or running bond ✓
  - Stack and running bond ✓
- (Any 2 × 1) (2)  
**[14]**

**QUESTION 4**

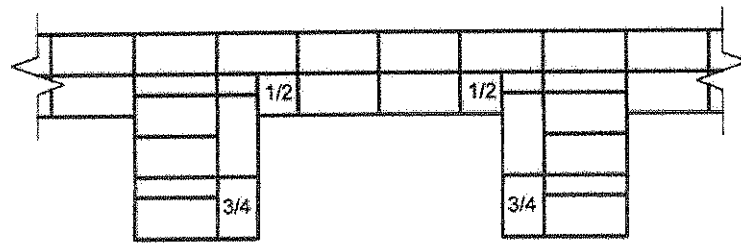

Approximate scale	= 2
Correct bonding to external wall	= 3
Correct bonding to internal projection	= 3
Correct bonding to main wall	= 2
	<u>10</u>

Course 1 of alternate plan course of a single-breasted fireplace in English bond with projection to only one side of the wall.

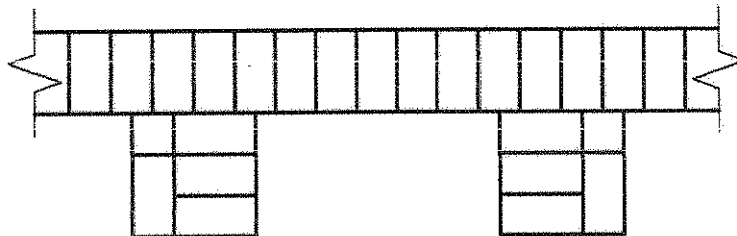

Approximate scale	= 2
Correct bonding to external wall	= 3
Correct bonding to internal projection	= 3
Correct bonding to main wall	= 2
	<u>10</u>

Course 2 of alternate plan course of a single-breasted fireplace in English bond with projection to only one side of the wall.

[20]

**QUESTION 5**

- 5.1
- The method of cutting and fixing ✓
  - Their shape camber ✓
  - The number of centre (point) from which the arches are set out. ✓ (3 × 1) (3)
- 5.2 This is a form of ringed arch ✓, built over a lintel ✓ on a shaped brick core ✓. (3)
- 5.3
- End joints should be made on joists ✓ and adjoining boards should not be jointed on the same joist ✓.
  - Boards should be well cramped ✓ up to close joints before nailing ✓.
  - Or alternative provision ✓ is to be made to ensure stability ✓.
  - Each board ✓ should be nailed with two nails to each joist ✓.
  - Nails should be well punched home. ✓ (Any 4 × 2) (8)
- [14]**

**QUESTION 6**

- 6.1 Face the ladder. ✓  
Place the ball of the foot ✓ on the rungs. ✓  
Always have one hand free ✓ when mounting a ladder. ✓  
Climb only one rung at a time ✓ and keep the free hand on the stile ✓ to prevent falling backwards. ✓  
The body should be kept centred between the stiles. ✓ (Any 8 × 1) (8)
- 6.2 Ensure that the area is level ✓ and free of obstructions. ✓  
Open the trestle legs ✓ and ensure that the collapsible stays are firmly in position. ✓  
Position the trestles the permissible distance apart ✓.  
Once positioned check the trestles for levelness and stability. ✓  
Ensure that the space between the trestle and the structure does not exceed 75 mm. ✓  
Remove the locating pins. ✓  
Adjust the trestle to the required working height ✓ and insert the locating pins. ✓  
Inspect the scaffolding planks for damage, projecting nails or any other obstruction. ✓  
Position the scaffolding planks to form a working platform. ✓  
Ensure that the end projection is correct, ✓ (Any 10 × 1) (10)
- [18]**

**TOTAL: 100**